

PRECAST CONCRETE & BLOCKWORK EXTERIOR WALL SYSTEMS

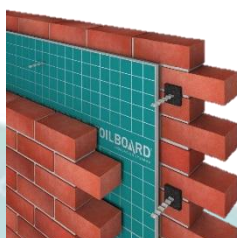

DOUBLE BRICK & BLOCKWORK CAVITY WALL SYSTEM

UNDERFLOOR INSULATION FOR BOTH NEW HOMES & RETRO-FIT

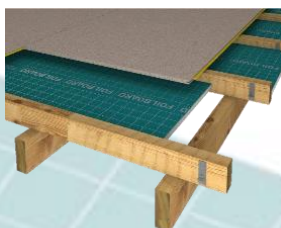

CATHEDRAL CEILING & SKILLION ROOF INSULATION

EXTERIOR WALL INSULATION



PERFECT FOR SLIMLINE APPLICATIONS BEHIND PLASTER BOARD

PRODUCT CODE	DESCRIPTION	IMAGE	QTY	COVERAGE	RECOMMENDED USE
FB041	Standard Fasteners		250	1 bag covers 15 sheets	Use to fix Foilboard GREEN 10 & 15 to timber wall frames and underfloor
FB042	Ultra Fasteners		250	1 bag covers 15 sheets	Use to fix Foilboard GREEN 20 & 25 to timber wall frames and underfloor
FB043	Blank Plates		250	1 bag covers 15 sheets	Use to fix Foilboard GREEN non standard screws & nails to wall frames and underfloor
FB044	Metal Fasteners		250	1 bag covers 15 sheets	Use to fix Foilboard GREEN 10 & 15 to steel wall frames, underfloor and purlins
FB045	Metal Ultra Fasteners		250	1 bag covers 15 sheets	Use to fix Foilboard GREEN 20 & 25 to steel wall frames, underfloor and purlins
FB051	Floor Saddles		200	45-50 m ²	Sits atop of joists to hold Foilboard GREEN panel in place before laying flooring down - for new builds
FB052	Floor Saddles		800	180 - 200m ²	Sits atop of joists to hold Foilboard GREEN panel in place before laying flooring down - for new builds
FB054	Flexifast		400	45-50 m ²	Used to fix Foilboard GREEN between framework / joist / purlins for retrofit underfloor
FB061	Green Tape		1	15 sheets per roll	Used to cover butt joints of Foilboard GREEN panel on the green anti-glare face
FB062	Silver Tape		1	10 sheets per roll	Used to cover butt joints of Foilboard GREEN panel on the silver face
FB071	Spacer Blocks		100	15-25m ²	Used to space Foilboard GREEN rigid panel in double brick cavity and commercial (concrete) walls

For further information, contact Foilboard's dedicated technical service **1800 354 717**

It's the smarter way to Insulate

FOILBOARD[®]
INSULATION SYSTEMS